



112 FINCHLEY ROAD
LONDON NW3 5HT
INFO@RHWESTATES.CO.UK
020 7431 7121

WWW.RHWESTATES.CO.UK



GREENCROFT GARDENS
SOUTH HAMPSTEAD
LONDON
NW6 3LJ

PRICE: £2,500 PCM

UNFURNISHED

We are delighted to offer this two-bedroom apartment on the first floor of a beautiful double-fronted Victorian residence located in this highly desirable, quiet South Hampstead address, ideally placed for Finchley Road's outstanding transport links and local amenities.

The apartment has just been subject to some renovation with new carpeting in the living room and hallway, and features a lovely bay window reception room and a separate kitchen with a window. A very large master bedroom with en suite bathroom/WC, second double bedroom, and a shower room/WC.

Available immediately on an unfurnished basis.

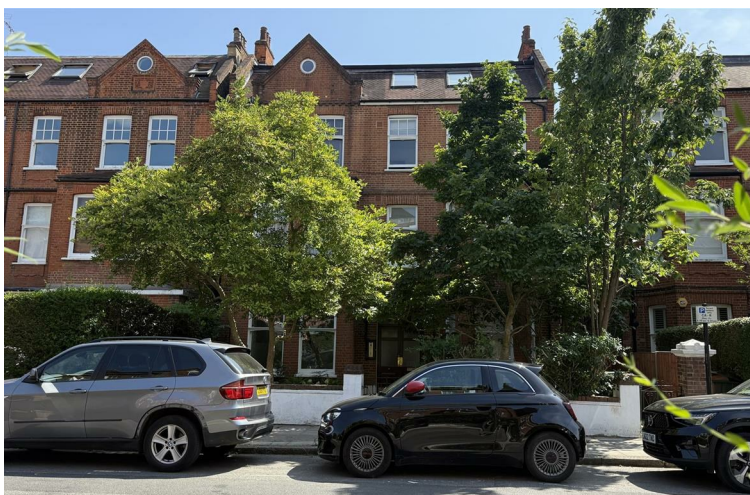

FEATURES:

- First floor conversion within Double fronted period residence
- Immaculate decorative condition
- 2 double bedrooms
- 2 bathrooms
- Unfurnished

First Floor

Approx. 68.9 sq. metres (741.8 sq. feet)

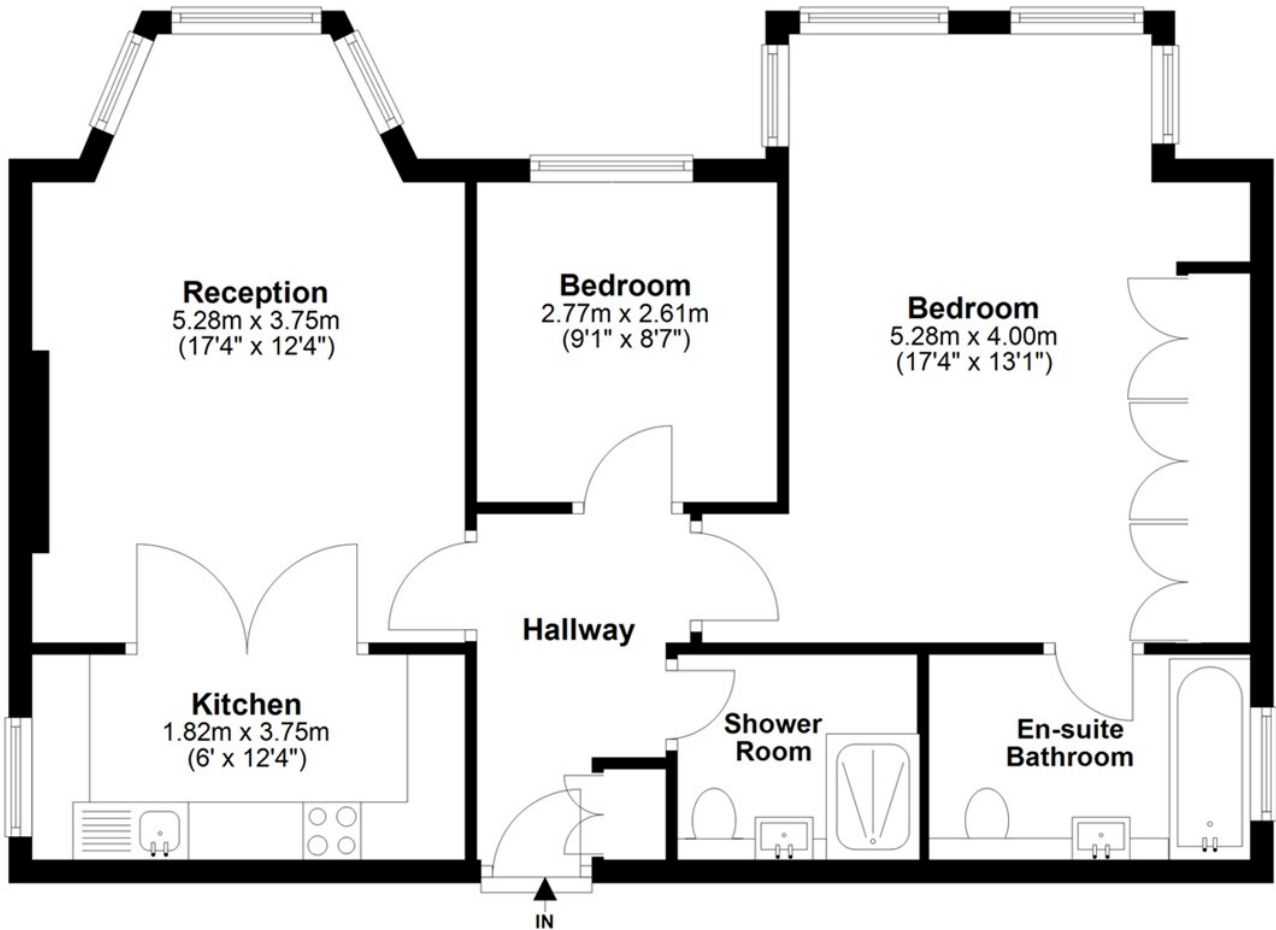

Total area: approx. 68.9 sq. metres (741.8 sq. feet)

Energy Efficiency Rating		
	Current	Potential
Very energy efficient - lower running costs		
(92 plus) A		
(81-91) B		
(69-80) C		80
(55-68) D	66	
(39-54) E		
(21-38) F		
(1-20) G		
Not energy efficient - higher running costs		
England & Wales		
EU Directive 2002/91/EC		

IMPORTANT NOTICE

Whilst every attempt has been made to ensure the accuracy of these details and floor plans contained here, measurements of doors, windows and rooms are approximate and no responsibility is taken for any error, omission or misstatement. These plans and details are for representation only as defined by RICS code of measuring practice and should be used as such by any prospective tenant. Not to scale. Copyright: RHW Estates

